

Schwenkbare Farbkamera

Benutzerhandbuch

Turning color camera

User Manual

Kääntyvä värikamera

Käyttöohje

Art.Nr. 471890

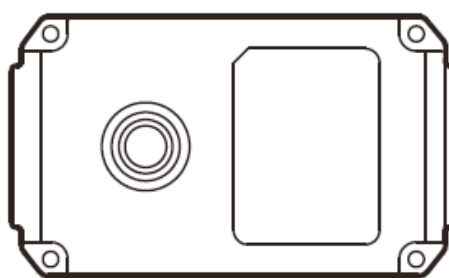
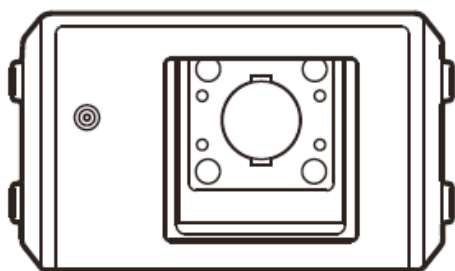

Vor Inbetriebnahme des Gerätes bitte diese Anweisungen aufmerksam lesen
Before operating the unit, please read the instructions carefully
Lue ohjeet huolellisesti ennen käyttöä



Features

- You can use the camera with 12V/200mA
- The camera utilizes a CCD image sensor giving a high quality picture.
- The camera automatically adjusts the picture quality with changing in light.
- Water-resistant housing
- Operates over a wide temperature range

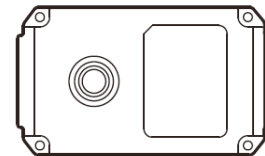
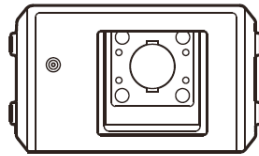

Camera input connector pin description

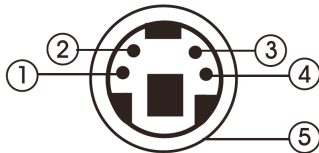

Pin No.	Description	
1	Video Output	white
2	Tilt Control Power DC 9V	blue
3	Audio Output	red
4	Plus DC 12V	yellow
5	Ground	black

Camera installation

- A. Attach the supplied mounting bracket to the vehicle. Adjust the angle of the camera and fasten the screws firmly.

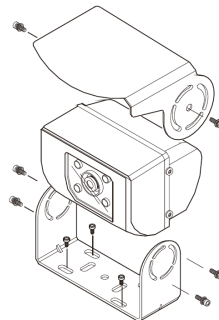

- B. Run the cable from the monitor to the camera

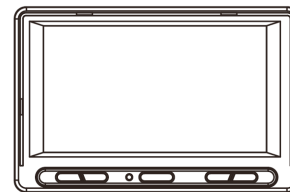

Specifications

- Image Interline transfer type CCD
- Picture elements NTSC : 270.000 pixels PAL : 320.000 pixels
- Image size 1/3 Inch
- Lens Maximum aperture F=2.0
- View angle 78° (Vertical), 104° (Horizontal), 130° (Diagonal)
- Synchronization International
- Horizontal resolution 330TV lines
- Required illumination 1.0 Lux
- Signal to noise ratio Better than 47 dB (at AGC off)
- Power supply DC 12V
- Power consumption 3.0W
- Operating temp. -30°C to +50°C (-22°F to +122°F)
- Weight 0.5kg
- Dimensions 91(W) x 53(H) x 78(D)mm
3.6(W) x 2.1(H) x 3.1(D) Inch
- Supplied Acc'y
 - Ø5 x 16L Stainless screw (4)
 - HEX M5XH5 Stainless (4)
 - W/washer Ø 5 x 16L Stainless screw (4)
 - W/washer Ø 4 x 10L Stainless screw (4)
 - Camera Bracket (1)
 - L-wrench 3mm (1)
 - Sunshield (1)